

01-30-14-92048-086-0050

U.S. DEPARTMENT OF HOMELAND SECURITY
 FEDERAL EMERGENCY MANAGEMENT AGENCY
 National Flood Insurance Program

ELEVATION CERTIFICATE

IMPORTANT: Follow the instructions on pages 1-9.

OMB No. 1660-0008
 Expiration Date: July 31, 2015

FL1309.0427EC

SECTION A - PROPERTY INFORMATION

FOR INSURANCE COMPANY USE

A1. Building Owner's Name
Selina Kok, Diane Daniel

A2. Building Street Address (including Apt., Unit, Suite, and/or Bldg. No.) or P.O. Route and Box No.
309 10TH AVENUE

City INDIAN ROCKS BEACH State FLORIDA ZIP Code 33785

A3. Property Description (Lot and Block Numbers, Tax Parcel Number, Legal Description, etc.)
LOT 5, BLOCK 88, FIRST ADDITION TO THE RE-REVISED MAP OF INDIAN BEACH SUBDIVISION, ACCORDING TO THE PLAT THEREOF, AS RECORDED IN PLAT BOOK 23, PAGE 11, 12 AND 13, OF THE PUBLIC RECORDS OF PINELLAS COUNTY, FLORIDA.

A4. Building Use (e.g., Residential, Non-Residential, Addition, Accessory, etc.) RESIDENTIAL

A5. Latitude/Longitude: Lat. 27 53 38.2 N Long. 82 50 39.2 W Horizontal Datum: NAD 1927 NAD 1983

A6. Attach at least 2 photographs of the building if the Certificate is being used to obtain flood insurance.

A7. Building Diagram Number 1A

A8. For a building with a crawlspace or enclosure(s):
 a) Square footage of crawlspace or enclosure(s) 0 sq ft
 b) Number of permanent flood openings in the crawlspace or enclosure(s) within 1.0 foot above adjacent grade 0
 c) Total net area of flood openings in A8.b 0 sq in
 d) Engineered flood openings? Yes No

A9. For a building with an attached garage:
 a) Square footage of attached garage 274 sq ft
 b) Number of permanent flood openings in the attached garage within 1.0 foot above adjacent grade 0
 c) Total net area of flood openings in A9.b 0 sq in
 d) Engineered flood openings? Yes No

SECTION B - FLOOD INSURANCE RATE MAP (FIRM) INFORMATION

B1. NFIP Community Name & Community Number CITY OF INDIAN ROCKS BEACH 125117

B2. County Name PINELLAS

B3. State FLORIDA

B4. Map/Panel Number 12103C - 0113 B5. Suffix G B6. FIRM Index Date 8/18/2009

B7. FIRM Panel Effective/Revised Date 09/03/03 B8. Flood Zone(s) AE B9. Base Flood Elevation(s) (Zone AO, use base flood depth) 10

B10. Indicate the source of the Base Flood Elevation (BFE) data or base flood depth entered in Item B9:
 FIS Profile FIRM Community Determined Other/Source: _____

B11. Indicate elevation datum used for BFE in Item B9: NGVD 1929 NAVD 1988 Other/Source: _____

B12. Is the building located in a Coastal Barrier Resources System (CBRS) area or Otherwise Protected Area (OPA)? Yes No
 Designation Date: _____ / _____ / _____ CBRS OPA

SECTION C - BUILDING ELEVATION INFORMATION (SURVEY REQUIRED)

C1. Building elevations are based on: Construction Drawings* Building Under Construction* Finished Construction
*A new Elevation Certificate will be required when construction of the building is complete.

C2. Elevations - Zones A1-A30, AE, AH, A (with BFE), VE, V1-V30, V (with BFE), AR, AR/A, AR/AE, AR/A1-A30, AR/AH, AR/AO. Complete Items C2.a-h below according to the building diagram specified in Item A7. In Puerto Rico only, enter meters.
 Benchmark Utilized: L-NET GPS NETWORK Vertical Datum: NAVD88

Indicate elevation datum used for the elevations in items a) through h) below. NGVD 1929 NAVD 1988 Other/Source: _____
 Datum used for building elevations must be the same as that used for the BFE.

Check the measurement used.

a) Top of bottom floor (including basement, crawlspace, or enclosure floor) 3 . 53 feet meters

b) Top of the next higher floor _____ feet meters

c) Bottom of the lowest horizontal structural member (V Zones only) _____ feet meters

d) Attached garage (top of slab) 3 . 23 feet meters

e) Lowest elevation of machinery or equipment servicing the building (Describe type of equipment and location in Comments) 3 . 23 feet meters

f) Lowest adjacent (finished) grade next to building (LAG) 3 . 27 feet meters

g) Highest adjacent (finished) grade next to building (HAG) 3 . 65 feet meters

h) Lowest adjacent grade at lowest elevation of deck or stairs, including structural support _____ feet meters

SECTION D - SURVEYOR, ENGINEER, OR ARCHITECT CERTIFICATION

This certification is to be signed and sealed by a land surveyor, engineer, or architect authorized by law to certify elevation information. I certify that the information on this Certificate represents my best efforts to interpret the data available. I understand that any false statement may be punishable by fine or imprisonment under 18 U.S. Code, Section 1001.

Check here if comments are provided on back of form. Were latitude and longitude in Section A provided by a licensed land surveyor? Yes No

Check here if attachments.

Certifier's Name <u>KEITH A. STEPHENSON</u>		License Number <u>LS 6521</u>	
Title <u>PROFESSIONAL SURVEYOR AND MAPPER</u>		Company Name <u>EXACTA LAND SURVEYORS, INC.</u>	
Address <u>11940 FAIRWAY LAKES DRIVE SUITE 1</u>		City <u>FT. MYERS</u>	State <u>FL</u>
Signature <u>Keith A. Stephenson</u>		ZIP Code <u>33913</u>	Telephone <u>P: (813) 549-4947</u>
Date <u>9/9/2013</u>			

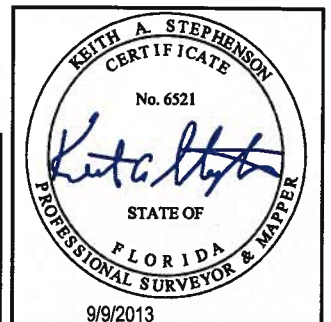

MNP

ELEVATION CERTIFICATE, page 2

IMPORTANT: In these spaces, copy the corresponding information from Section A.			FOR INSURANCE COMPANY USE	
Building Street Address (including Apt., Unit, Suite, and/or Bldg. No.) or PO. Route and Box No. 309 10TH AVENUE			Policy Number:	
City INDIAN ROCKS BEACH	State FL	ZIP Code 33785	Company NAIC Number:	

SECTION D – SURVEYOR, ENGINEER, OR ARCHITECT CERTIFICATION (CONTINUED)

Copy both sides of this Elevation Certificate for (1) community official, (2) insurance agent/company, and (3) building owner.

Comments **NOTE: C2.E = HOT WATER TANK. NOTE: THIS ELEVATION CERTIFICATE IS ONLY VALID FOR THE PERSON OR PERSONS NAMED ON THIS CERTIFICATE. THIS CERTIFICATE IS FOR FLOOD INSURANCE PURPOSES ONLY. THE INFORMATION ON THIS CERTIFICATE SHOULD NOT BE USED FOR CONSTRUCTION OR PLANNING.**

Signature *Kate Holt* Date 9/9/2013 CENTERLINE ROAD ELEVATION: 3.15

SECTION E – BUILDING ELEVATION INFORMATION (SURVEY NOT REQUIRED) FOR ZONE AO AND ZONE A (WITHOUT BFE)

For Zones AO and A (without BFE), complete Items E1–E5. If the Certificate is intended to support a LOMA or LOMR-F request, complete Sections A, B, and C. For Items E1–E4, use natural grade, if available. Check the measurement used. In Puerto Rico only, enter meters.

- E1. Provide elevation information for the following and check the appropriate boxes to show whether the elevation is above or below the highest adjacent grade (HAG) and the lowest adjacent grade (LAG).
 - a) Top of bottom floor (including basement, crawlspace, or enclosure) is _____ . _____ feet meters above or below the HAG.
 - b) Top of bottom floor (including basement, crawlspace, or enclosure) is _____ . _____ feet meters above or below the LAG.
- E2. For Building Diagrams 6–9 with permanent flood openings provided in Section A Items 8 and/or 9 (see pages 8–9 of Instructions), the next higher floor (elevation C2.b in the diagrams) of the building is _____ . _____ feet meters above or below the HAG.
- E3. Attached garage (top of slab) is _____ . _____ feet meters above or below the HAG.
- E4. Top of platform of machinery and/or equipment servicing the building is _____ . _____ feet meters above or below the HAG.
- E5. Zone AO only: If no flood depth number is available, is the top of the bottom floor elevated in accordance with the community's floodplain management ordinance? Yes No Unknown. The local official must certify this information in Section G.

SECTION F – PROPERTY OWNER (OR OWNER'S REPRESENTATIVE) CERTIFICATION

The property owner or owner's authorized representative who completes Sections A, B, and E for Zone A (without a FEMA-issued or community-issued BFE) or Zone AO must sign here. The statements in Sections A, B, and E are correct to the best of my knowledge.

Property Owner or Owner's Authorized Representative's Name _____

Address _____	City _____	State _____	ZIP Code _____
Signature _____	Date _____	Telephone _____	
Comments _____			

Check here if attachments.

SECTION G – COMMUNITY INFORMATION (OPTIONAL)

The local official who is authorized by law or ordinance to administer the community's floodplain management ordinance can complete Sections A, B, C (or E), and G of this Elevation Certificate. Complete the applicable item(s) and sign below. Check the measurement used in Items G8–G10. In Puerto Rico only, enter meters.

- G1. The information in Section C was taken from other documentation that has been signed and sealed by a licensed surveyor, engineer, or architect who is authorized by law to certify elevation information. (Indicate the source and date of the elevation data in the Comments area below.)
- G2. A community official completed Section E for a building located in Zone A (without a FEMA-issued or community-issued BFE) or Zone AO.
- G3. The following information (Items G4–G10) is provided for community floodplain management purposes.

G4. Permit Number _____	G5. Date Permit Issued _____	G6. Date Certificate Of Compliance/Occupancy Issued _____
G7. This permit has been issued for: <input type="checkbox"/> New Construction <input type="checkbox"/> Substantial Improvement		
G8. Elevation of as-built lowest floor (including basement) of the building: _____ . _____	<input type="checkbox"/> feet <input type="checkbox"/> meters	Datum _____
G9. BFE or (in Zone AO) depth of flooding at the building site: _____ . _____	<input type="checkbox"/> feet <input type="checkbox"/> meters	Datum _____
G10. Community's design flood elevation: _____ . _____	<input type="checkbox"/> feet <input type="checkbox"/> meters	Datum _____

Local Official's Name _____	Title _____
Community Name _____	Telephone _____
Signature _____	Date _____
Comments _____	

Check here if attachments.